

# SER200 L4L SERIES

Normal-Duty Bearing Insert with Snap Ring  
Setscrew Lock

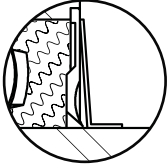

Features:



**Permanent Lubrication**  
Standard with seals and flinger

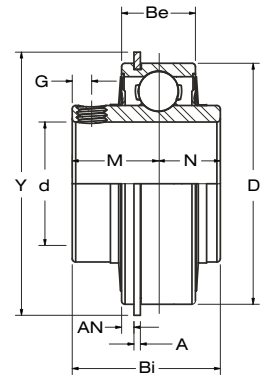

Bearing Insert	Shaft Dia.	Setscrews Used	Dimensions in.									Load Rating		Weight
	d mm.	in. mm.	D	Bi	Be	N	M	A	AN	Y	G	Dynamic Cr	Static Cor	lbs. kg.
SER201 L4L	12	M6 x 1	1.8504 47.0	1.2205 31.0	0.6260 15.9	0.4055 10.3	0.8150 20.7	0.0421 1.1	0.0937 2.4	2.0748 52.7	0.1969 5.0	2,147 9.55	1,075 4.78	0.6 0.3
SER201 8 L4L	1/2	1/4-28												
SER202 L4L	15	M6 x 1												
SER202 10 L4L	5/8	1/4-28	1.8504 47.0	1.2205 31.0	0.6260 15.9	0.4055 10.3	0.8150 20.7	0.0421 1.1	0.0937 2.4	2.0748 52.7	0.1969 5.0	2,883 12.82	1,496 6.65	0.6 0.3
SER203 L4L	17	M6 x 1												
SER204 L4L	20	M6 x 1												
SER204 12 L4L	3/4	1/4-28	2.0472 52.0	1.3740 34.9	0.7480 19.0	0.5157 13.1	0.8583 21.8	0.0421 1.1	0.0937 2.4	2.2795 57.9	0.2087 5.3	3,155 14.04	1,810 8.05	0.6 0.3
SER205 14 L4L	7/8	1/4-28												
SER205 15 L4L	15/16	1/4-28												
SER205 16 L4L	1	1/4-28	2.4409 62.0	1.5000 38.1	0.8740 22.2	0.6260 15.9	0.8740 22.2	0.0650 1.7	0.1252 3.2	2.6655 67.7	0.2165 5.5	4,377 19.47	2,569 11.43	0.8 0.4
SER206 17 L4L	1 1/16	1/4-28												
SER206 18 L4L	1 1/8	1/4-28												
SER206 19 L4L	1 3/16	1/4-28	2.8346 72.0	1.6890 42.9	0.9370 23.8	0.6890 17.5	1.0000 25.4	0.0650 1.7	0.1252 3.2	3.0945 78.6	0.2520 6.4	5,775 25.69	3,497 15.56	1.2 0.6
SER206 20 L4L	1 1/4	1/4-28												
SER207 L4L	35	M8 x 1												
SER207 20 L4L	1 1/4	5/16-24	3.1465 80.0	1.9370 49.2	1.0945 27.8	0.7480 19.0	1.1890 30.2	0.0650 1.7	0.1252 3.2	3.4094 86.6	0.3150 8.0	6,634 29.51	4,079 18.14	1.9 0.9
SER207 21 L4L	1 5/16	5/16-24												
SER207 22 L4L	1 3/8	5/16-24												
SER207 23 L4L	1 7/16	5/16-24	3.3465 85.0	1.9370 49.2	1.0945 27.8	0.7480 19.0	1.1890 30.2	0.0650 1.7	0.1252 3.2	3.6063 91.6	0.3150 8.0	7,160 31.85	4,676 20.80	2.1 1.0
SER208 24 L4L	1 1/2	5/16-24												
SER208 25 L4L	1 9/16	5/16-24												
SER208 26 L4L	1 5/8	5/16-24	3.5433 90.0	2.0315 51.6	1.1260 28.6	0.7480 19.0	1.2835 32.6	0.0949 2.4	0.1252 3.2	3.7992 96.5	0.3937 10.0	7,867 35.00	5,330 23.71	2.3 1.0
SER209 27 L4L	1 11/16	5/16-24												
SER209 28 L4L	1 3/4	5/16-24												
SER209 29 L4L	45	M8 x 1	3.9370 100.0	2.1890 55.6	1.1890 30.2	0.8740 22.2	1.3150 33.4	0.0949 2.4	0.1252 3.2	4.1929 106.5	0.3937 10.0	9,743 43.34	6,608 29.40	2.7 1.2
SER210 30 L4L	1 7/8	3/8-24												
SER210 31 L4L	1 15/16	3/8-24												
SER210 32 L4L	2	3/8-24	4.3307 110.0	2.5630 65.1	1.2520 31.8	1.0000 25.4	1.5630 39.7	0.0949 2.4	0.1240 3.2	4.5906 116.6	0.3937 10.0	10,720 47.69	7,516 33.43	3.7 1.7
SER210 33 L4L	2	3/8-24												
SER211 32 L4L	2	3/8-24												
SER211 34 L4L	2 1/8	3/8-24	5.1181 130.0	3.0630 77.8	1.5000 38.1	1.3110 33.3	1.7520 44.5	0.1220 3.1	0.1614 4.1	5.5000 139.7	0.4724 12.0	14,974 66.61	10,757 47.85	5.3 2.4
SER211 35 L4L	2 3/16	3/8-24												
SER212 36 L4L	2 1/4	3/8-24												
SER212 37 L4L	60	M10 x 1.25	5.1181 130.0	3.0630 77.8	1.5000 38.1	1.3110 33.3	1.7520 44.5	0.1220 3.1	0.1614 4.1	5.5000 139.7	0.4724 12.0	14,974 66.61	10,757 47.85	5.3 2.4
SER212 38 L4L	2 3/8	3/8-24												
SER212 39 L4L	2 7/16	3/8-24												
SER215 47 L4L	2 15/16	7/16-20	5.1181 130.0	3.0630 77.8	1.5000 38.1	1.3110 33.3	1.7520 44.5	0.1220 3.1	0.1614 4.1	5.5000 139.7	0.4724 12.0	14,974 66.61	10,757 47.85	5.3 2.4
SER215 48 L4L	3	7/16-20												

\*Listed bearings will need an L4L suffix for proper ordering. Example: UCP205 16 L4L.